



# Bert Frank Riddle Single Wall Light

LA10436/SW

SOURCE: <https://www.davidvillagelighting.co.uk/product/Bert-Frank-Riddle-Single-Wall-Light/10000160>

## PRODUCT DESCRIPTION

### Riddle Single Wall Light by Bert Frank

The Riddle Single wall lamp is a contemporary and stylish light, made from beautiful machined-brass with black embellishment. The lampshade has tiny holes and a fabric insert which allows the light to diffuse outwards in a glare-free way for a wonderful ambience. The light also escapes out of the bottom for a directional glow which can be manipulated by moving the flexible shade.

The wall light can be used in many settings, whether you need a bedside reading light or atmospheric hallway lighting. The top-quality use of materials and the modern aesthetic make the Riddle Single wall light a wonderful addition to homes and work spaces. Use alongside other lights from the [Bert Frank Riddle collection](#) for a complete look.



## PRODUCT SPECIFICATION

- Light Source:** 1 x Max 4W G9 LED (included)
- IP Code:** 20
- Dimming:** Dimmable via mains phase dimming.
- Dimensions:** Ø12cm  
Height: 19cm  
Depth: 18cm  
Wall Base: Ø8cm

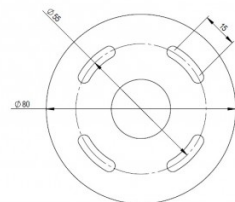
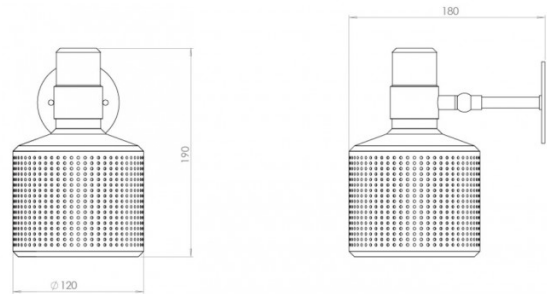

WALL PLATE



For all sales and technical enquiries, please contact:

+44 (0)114 263 4266

info@davidvillagelighting.co.uk

www.davidvillagelighting.co.uk