



Terzani Mizu 1-Light Suspension

LA9475-1 LIGHT

SOURCE: <https://www.davidvillagelighting.co.uk/product/Terzani-Mizu-1-Light-Suspension/10572>



PRODUCT DESCRIPTION

Designer: Terzani Lab

Beautiful Terzani Mizu 1-Light Suspension: Inspired by the tranquil and mesmerizing high refractions created by water, Mizu is a new, customizable pendant light from Terzani.

Like water droplets, no two Mizu are alike, each crystal shape is unique and made meticulously by hand. Using only the clearest crystal (24% lead), Mizu perfectly emulates water's refraction of light, casting amazing patterns around the room, reminiscent of flowing water.

Provides ambient and decorative illumination.

Materials: 24% Lead Crystal

Also available in:

Brushed nickel with clear/silver dust glass

White with clear gold glass

Please [contact us](#) for more details and a quotation.

CUSTOMISED SPECIALS ARE ALSO AVAILABLE ON THIS LIGHT

PRODUCT SPECIFICATION

Light Source: 1 x max 10W G4 (excluded)

Dimming: Dimmable with Triac/IGBT dimming systems

Dimensions: Ø11cm
10cm shade height
Ø12cm ceiling canopy
190cm drop

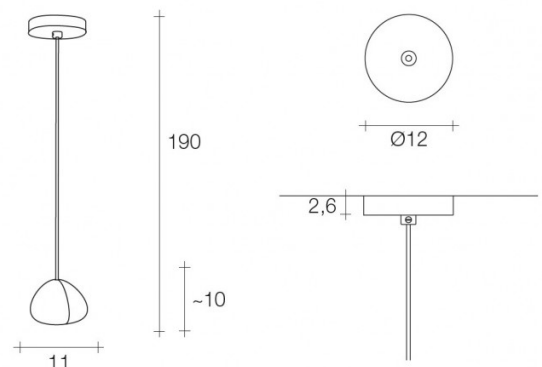



For all sales and technical enquiries, please contact:

+44 (0)114 263 4266

info@davidvillagelighting.co.uk

www.davidvillagelighting.co.uk