

BERT | FRANK

LA10436/SW

## Bert Frank Riddle Single Wall Light

SOURCE: <https://www.davidvillagelighting.co.uk/product/Bert-Frank-Riddle-Single-Wall-Light/10000160>

### PRODUCT DESCRIPTION

#### Riddle Single Wall Light by Bert Frank

The Riddle Single wall lamp is a contemporary and stylish light, made from beautiful machined-brass with black embellishment. The lampshade has tiny holes and a fabric insert which allows the light to diffuse outwards in a glare-free way for a wonderful ambience. The light also escapes out of the bottom for a directional glow which can be manipulated by moving the flexible shade.

The wall light can be used in many settings, whether you need a bedside reading light or atmospheric hallway lighting. The top-quality use of materials and the modern aesthetic make the Riddle Single wall light a wonderful addition to homes and work spaces. Use alongside other lights from the [Bert Frank Riddle collection](#) for a complete look.



### PRODUCT SPECIFICATION

**Light Source:** 1 x Max 4W G9 LED (included)  
**IP Code:** 20  
**Dimming:** Dimmable via mains phase dimming.  
**Dimensions:** Ø12cm  
 Height: 19cm  
 Depth: 18cm  
 Wall Base: Ø8cm

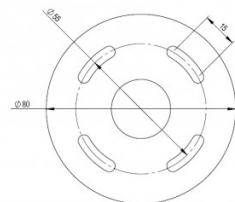
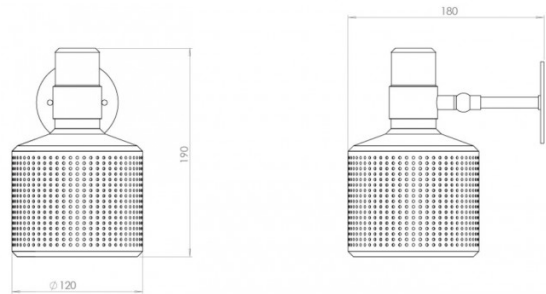

WALL PLATE



**For all sales and technical enquiries, please contact:**

+44 (0)114 263 4266

[info@davidvillagelighting.co.uk](mailto:info@davidvillagelighting.co.uk)

[www.davidvillagelighting.co.uk](http://www.davidvillagelighting.co.uk)